

MarTest 802 EW

Digital 3D Touch Probe



FUNCTIONS

- Functions:
- ON/OFF
- Auto OFF after 2 hours

FEATURES

Excellent readability thanks to combined display:

- bar graph for dynamic path information
- digital display for exact readings

- Can be controlled independently of a machine tool
- Large working range in all axes (X, Y, Z) prevents damage to the stylus by contacting errors
- Compact metal housing and long probe arm
- Shockproof movement
- IP protection category: IP 65
- Package contains: battery, instruction manual, stylus 802 EWt

Application:

- Can be used on milling and CNC machines to
- determine the zero position on workpieces
 - determine the center of bores
 - determine and correct the alignment of a workpiece and for the measurement of
 - lengths
 - depths



TECHNICAL DATA

Order no.	4304300	
Product type	802 EW	
Resolution	mm	0.005
Working areas, X-, Y-, Z-axis	-2 to 4 mm	
Repeatability at zero point, uni-directional	inch	± 0.005 mm
Standard	Factory standard	

Order no.	Mounting shaft
	mm
4304300	16

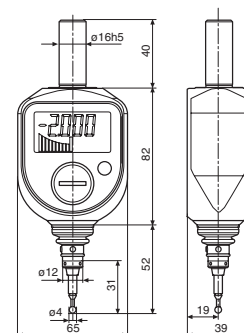

ACCESSORIES

Order no.	Product name	Product type
4304320	Stylus \varnothing 4.0 mm, l = 31 mm	802 EWt
4102520	Battery 3 V, CR 2032	

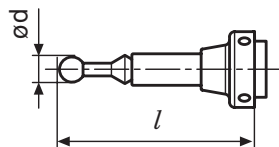

802 EWt;802 NWt

MarTest 802 NW

Mechanical 3D Touch Probe



FEATURES

- Large, high contrast dial face
- Can be controlled independently of a machine tool
- Large working range in all axes (X, Y, Z) prevents damage to the stylus by contacting errors
- Compact metal housing and long probe arm
- High accuracy and linearity
- Shockproof and waterproof, ideal for the use on a machine with a tool changer
- **IP protection category:** IP 67
- **Package contains:** battery, instruction manual, stylus 802 EWt

Application:

Can be used on milling and CNC machines to

- determine the zero position on workpieces
- determine the center of bores
- determine and correct the alignment of a workpiece and for the measurement of
- lengths
- depths



TECHNICAL DATA

Order no.	4304311	
Product type	802 NW	
Graduation value	mm	0.01
Working areas, X-, Y-, Z-axis	6.6 mm	
Repeatability at zero point, uni-directional	inch	± 0.01mm
Standard	Factory standard	

Order no.	Mounting shaft
	mm
4304311	16

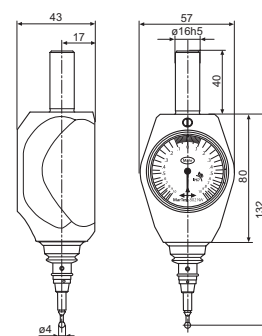

ACCESSORIES

Order no.	Product name	Product type
4304320	Stylus \varnothing 4.0 mm, l = 31 mm	802 EWt
4304321	Stylus \varnothing 6 mm, l = 56.6 mm	802 NWt

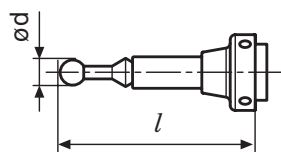

802 EWt;802 NWt